



# Goleta DEPOT DISPATCH



**Newsletter of the South Coast Railroad Museum**  
*Volume 25, Number 1 — Spring 2005*

## Hop Aboard “Easter Bunny Express” On March 26

What’s the best day for a family visit to the railroad museum? Many folks in the know won’t hesitate with their answer: It’s the *Easter Bunny Express*.

This year the always-anticipated springtime ritual will be held at the museum on Saturday, March 26, from 11 a.m. until 4 p.m. The cost is \$3 per person, adult or child.



Those holding the special oversized egg-shaped ticket will be entitled to take part in a number of fun activities, including visits to

*Wabbit-Twacks Station* (to ride the decorated train); *Harvey’s House* (for a cookie & lemonade donated by **Country Catering Co.**); *Easter-Bunnyville* (to meet the **Easter Bunny** and receive an egg surprise); *Jack-Rabbit Junction* (to enter a prize drawing); and *What’s Up Dock* (to collect another event souvenir).

Tickets are available in advance at the museum. They will be sold during the event until 3:30 p.m.

With all of the rain, the grounds should be beautiful for

*It wouldn’t be the  
Easter Bunny  
Express without  
you know who!*

the event. Many of the trees and shrubs are already in full bloom and the spring flowers shouldn’t be far behind. For the event, we always add plenty of fun signs to complete the setting.

As an added event highlight, we’ll have the new Visitor Center doors open, so you can see the construction progress firsthand (see page 4 story for photos and details).

For those wishing to enjoy lunch or an afternoon snack, our volunteers will be serving hot sandwiches, snacks and refreshments throughout the event.

Don’t be left at the station! The 2005 *Easter Bunny Express* is sure to be another “hare-raising egg-sperience” for the whole family (rain date: April 2).

The museum will be closed on Easter Sunday, March 27.

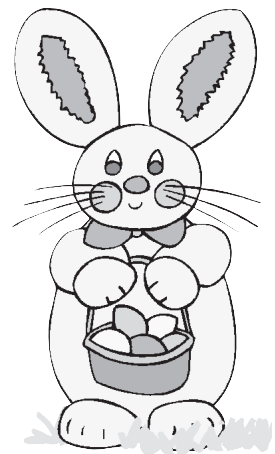

*Sign urges “Support Rabbit Transit.”*

## South Coast Railroad Museum Institute for American Research

### Board of Trustees

David Chapman  
Joan Hanna  
Kip Kramer  
Noel Langle  
Bruce Morden  
Ken Pontifex  
Richard B. Shelton

### Officers — 2005

Richard B. Shelton, *President*  
Ken Pontifex, *Vice President*  
Kip Kramer, *Secretary*  
David Chapman, *Treasurer*

### Senior Staff

Gary B. Coombs, *Ph.D., Director*  
Phyllis J. Olsen, *Asst. Director*  
Thea H. Cremers, *Resource  
Development Coordinator*

# Thank You

## for Supporting *Super Saturday IX*

Trains ran at or near capacity all afternoon on Feb. 5, during the 9th Annual *Super Saturday!* The event was made possible by the generous support of a record 19 event sponsors. They included Mark Carr, D.D.S.; Circle of Friends Children's Center; Michael J. Gartzke, CPA; Grace Baptist Church; Bartlett Tree Experts; Bob Locke; Montessori Center School; D & B Communications; Ramada Limited; Mike and Gail Pearl, Pitts & Bachmann Realtors; Penfield & Smith; Dick and Wendy Shelton; RP Printing; Gold's Gym; Peter Tiersma; Dal Pozzo Tire Corp., Goleta; Kids' Club; State Farm Insurance - Ed Attlesey & Tammy Dobrotin, Agents; and the Goleta Valley Voice.

## Spring Fundraiser Is May 21

The museum's 24th annual Spring Fundraiser will be held Saturday, May 21. The event will include unlimited free miniature train and handcar rides for all museum visitors.

We are now looking for volunteers to help with the fundraising. Each year, this event covers about 15% of the museum's annual operating costs. Please support the spring fundraiser with your tax-deductible donation and enjoy the free rides on May 21!

The first Spring Fundraiser, which was called the "Asphalt Regatta" for many years, was held at Goleta Beach

on April 24, 1982, barely five months after a dilapidated Goleta Depot had been moved from its trackside site to a new home at Lake Los Carneros County Park. The inaugural event raised about \$1,500 for the campaign to save and preserve the historical landmark.

Members are encouraged to make history by taking part in this year's event, by collecting pledges or making a personal pledge. A pledge form accompanies this newsletter. For more information about the event and how you can help, please contact Gary or Phyllis at the museum (805-964-3540).

*Participants in the 5th annual (1986) Spring Fundraiser ("Asphalt Regatta").*



## Welcome New Members

The Woman's Service Club of Goleta is a new Milepost 100 member. Kathy Chalfant is a new member and a new addition to the museum's *Coast Starlight* Interpretive Program.

New members of the Junior Engineers Club are Cayden Colasse, Shane Dixon, Dylan Ross Bienstock, Christopher Hartman, Matthew Hartman, Joshua Rowe, Carl Simpson-Heil, David Simpson-Heil and Sara Weitzel.

A warm welcome to all of these new members of the museum family.

## Depot Day Sept. 25

**Goleta Depot Dispatch:** Newsletter of the South Coast Railroad Museum.

Published quarterly by the Institute for American Research, 300 North Los Carneros Rd., Goleta, CA 93117-1502.

To contact us:

Phone: 805-964-3540;

FAX: 805-964-3549

E-mail: [museum@goletadepot.org](mailto:museum@goletadepot.org)

Web-site: [www.goletadepot.org](http://www.goletadepot.org)

## Shelton To Head Museum Trustees; Hanna Joins Board

The Board of Trustees has elected **Richard Shelton** as its president for 2005. Dick Shelton moved here from Pennsylvania in the summer of 1987 to become Superintendent of the

Goleta Union School District. He was accompanied by his wife, Wendy, and their son and daughter, Jeffrey and Leslie.

Dick retired from Goleta schools in January 2000, having completed about 39 total years in the education field, where he holds a doctorate degree.



*Dick Shelton*

Shelton is one of the museum's longest-serving trustees. He was on the board from 1994 to 1999 and again starting in 2002. He served as president in 1995.

Other officers for 2005 are **Kip Kramer**, Vice President; **Bruce Morden**, Secretary; and **David Chapman**, Treasurer.

**Joan Hanna** is a new member of the Board of Trustees. Retired after 30 years as Executive Assistant to the

Superintendent of the Goleta Union School District, Joan remains very active with church and local community groups. She is a longtime member and past president of the Woman's Service Club of Goleta, and a new member of the Santa Barbara Woman's Club.

Her connection with trains goes back to her childhood in Paris, Illinois, where the family home was just two doors away from the railroad tracks. Joan recalls, "When I picture it in my mind I can still feel the power of the engines moving the wheels, especially when starting from a standstill, and hear the sounds of the couplers when the trains jerked forward or back. They were mostly freight trains, but one particular fond memory was the day a trainload of soldiers passed by and they threw chewing gum and candy to us."



*Joan Hanna*

Joan moved to California in 1959, settling in Santa Barbara in 1964. She and her former husband have four daughters and five grandchildren, all living in Santa Barbara or Lompoc.

## VOLUNTEER NEWS

### Museum Gearing Up For Expanded Rail Program To Oakland; Volunteers Needed

Amtrak has asked the museum to begin the much-anticipated expanded version of its interpretive program aboard the *Coast Starlight* effective May 30. The expanded program is based around a two-day roundtrip to Oakland. During each *Coast Starlight* trip, teams of two museum volunteer guides will interact with passengers and use the train's public-address system to describe local history, points of interest, natural history, and things to do along the railroad route.

The Oakland program is a companion to the museum's Santa Barbara-to-

San Luis Obispo program, which has been in operation since 1998. Both are offered in cooperation with the Trails & Rails program of the National Park Service.

The museum needs to add about 10 new guides in order to fulfill the four-days-a-week schedule that Amtrak has requested. Currently, there are 23 volunteers in the program.

Among the program's many benefits, guides receive free overnight accommodations at the Jack London Inn in Oakland's Jack London Square and complimentary

meals aboard the *Coast Starlight*.

Readers who are interested in applying for the program, or who wish to obtain additional information, are urged to call the museum office any weekday afternoon (964-3540) or contact Museum Director Gary Coombs by e-mail ([gcoombs@goletadepot.org](mailto:gcoombs@goletadepot.org)).

## Preview the Electronic Information Center March 26

On March 26, from 11 a.m. until 4 p.m., during the *Easter Bunny Express* event, there will be a special preview of the electronic kiosk, or "Information Station," that will become a permanent feature of the new Visitor Center. Funded by a grant from the Institute of Museum and Library Services (IMLS), with additional support from Kodak and Microsoft, among others, the computer-based project combines a number of educational and other functions, including a guest book for visitors, a virtual library for researchers, and orientation information for

*Fragment of a detailed blueprint map showing the Goleta railroad yard, as it existed in 1930. From the South Coast Railroad Museum Collections*

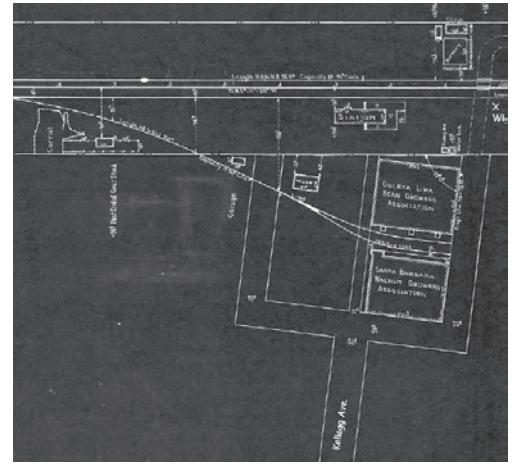

first-time museum guests.

When completed, it will contain a wealth of information about Goleta Depot, local history, regional railroad history, the Southern Pacific Co., and trains and railroading in general. It already contains copies of rare photographs, maps and documents from the

museum collections, which any kiosk users can view. Among its many holdings is a complete, searchable copy of all 24 volumes of the *Depot Dispatch* newsletter, going back to 1981.

Museum Director Gary Coombs, who has been spearheading the project, will be on hand during the March 26 preview to share the kiosk's features and resources and answer questions.

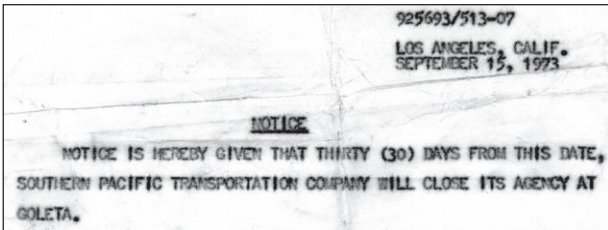

*With this Sept. 15, 1973 notice (fragment shown here), Southern Pacific announced that it would permanently close Goleta Depot in 30 days. From the South Coast Railroad Museum Collections.*

## Visitor Center Progress

Both doors and all of the windows save one have now been expertly installed in the new Visitor Center. Most of the current work is being done on Saturdays by Trustees **Noel Langle** and **David Chapman**. If you have construction skills and would like to lend a hand, please give the office a call (805-964-3540, weekday afternoons), or contact Museum Director Gary Coombs by e-mail ([gcoombs@goletadepot.org](mailto:gcoombs@goletadepot.org)).

The rough wiring, including installation of the flex cable and the outlet and switch boxes, should be in place in the next few weeks, to be followed by the exterior siding and interior walls.

We will have the building open on Saturday, March 26, during the *Easter Bunny Express*, so that event attendees can see the progress that has been made on the construction.

*David Chapman gets SWAP-worker help to position one of the large side windows.*



*The new building is beginning to take on a familiar look.*



*Noel Langle installs door hardware.*

